

TMAA01-05 and TMAA01-07 Options Extender Boards Installation Instructions



Introduction

The TMAA01-05 and TMAA01-07 options-extender boards provide external access to most of the signal lines provided by the radio's internal options connector.

The options-extender board fits inside the radio in the options cavity and is connected to the main PCB by the internal options connector and loom.

The internal options connector signals are then made available on the high-density 15-way D-range connector mounted on the options-extender board. This connector fits through the external options connector hole provided in the radio chassis.



Important: The radio does not meet the IP54 protection standard once an options-extender board has been installed unless the external options cover seal is installed.

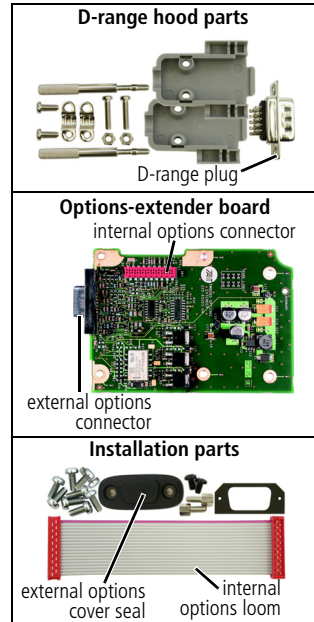

Installation Warning



Important: This equipment contains devices that are susceptible to static charges. The procedures outlined in this installation guide should therefore be carried out in a static-safe environment. You can obtain information on antistatic precautions and the dangers of electrostatic discharge (ESD) from standards such as ESD S4.1-1997 (revised) or BS EN 100015-4 1994. The Electrostatic Discharge Association website is <http://www.esda.org/>.

Installing an Options-Extender Board

Parts Required

The following table describes the parts required to install an options-extender board in a radio. The parts marked with an asterisk (*) are not shown in the diagram and are used to connect to the radio's external options connector.

Parts required for installation

Quantity	Internal Part Number	Description	Reference
1	362-01111-XX ^a	foam seal	③
1	362-01108-XX ^a	cover seal	⑪
2	347-00011-00	4-40x3/16 screws	⑫
2	354-01043-00	screw-lock fasteners	⑦
6	349-02062-00	M3x8 screws	⑨
★1	240-00010-80	D-range plug	—
★1	240-06010-29	D-range hood	—

a. Contact Technical Support for the exact IPN (Internal Part Number).

Options extender board installation

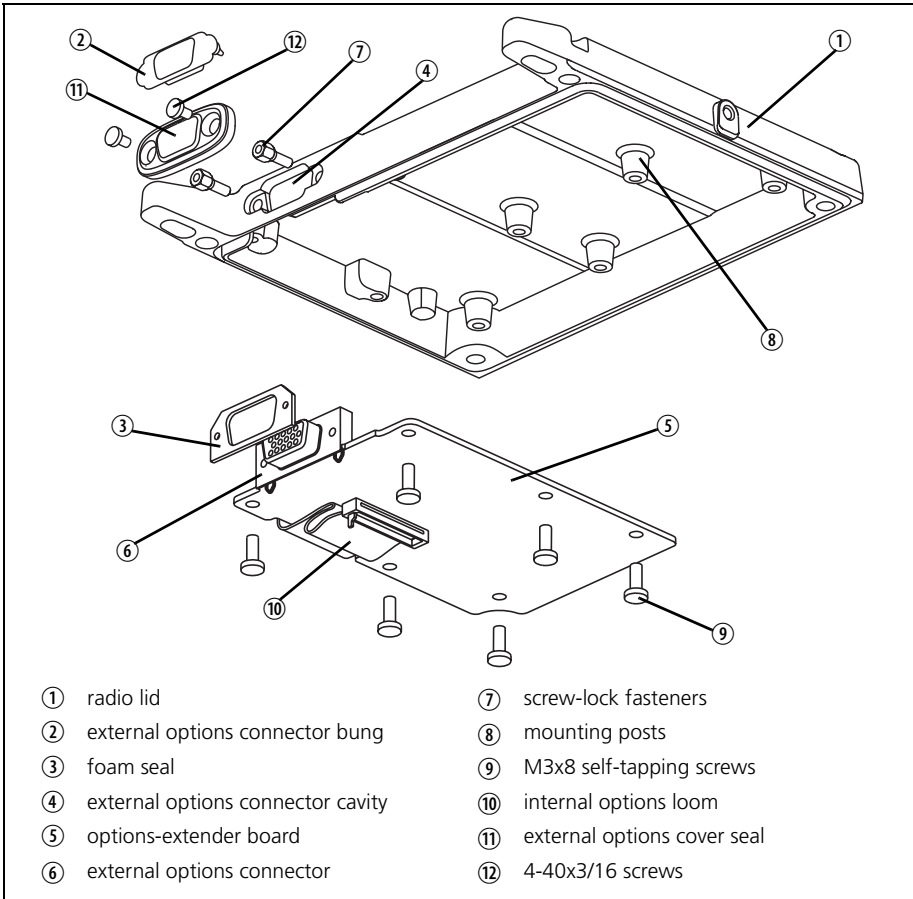

Installation Procedure

1. Disassemble the radio in order to gain access to the options cavity.
For detailed disassembly instructions, refer to the disassembly procedure in the service manual.
The circled numbers in the following instructions refer to items in the diagram on the previous page
2. Remove the top cover and lid ① from the radio to access the options cavity.
3. Remove the external options connector bung ②, if it is fitted.
4. On the inside of the radio lid place the foam seal ③ over the external options connector cavity ④.
5. With the top side of the options-extender board ⑤ facing the radio lid, guide the external options connector ⑥ (the D-range connector on the options-extender board) into the external options connector cavity.
6. Screw the external options connector to the radio lid using the two screw-lock fasteners ⑦.
7. Tighten the fasteners to a torque of 0.9N·m (8lbf·in).



Important: The external options connector screw-lock fasteners must be tightened correctly before screwing the options-extender board onto the mounting posts ⑧.

8. Screw the options-extender board to the mounting posts on the radio lid using four M3x8 self-tapping screws ⑨.
Tighten the M3x8 screws to a torque of 1.9N·m (17lbf·in)



Important: For the options-extender board to be installed correctly in the radio's options cavity, the internal options connector loom ⑩ must be looped in the way shown in the diagram on the previous page.

9. Plug the unattached end of internal options connector loom ⑩ into the internal options connector on the radio main PCB.
10. Refit the radio lid and top cover to the radio and screw the external options cover seal ⑪ over the external options connector, using the two 4-40x3/16 screws ⑫.

More Information

Technical note TN-1260-AN provides information on how to configure the TMAA01-05 and TMAA01-07 boards. Contact Technical Support for further assistance:

E-mail: support@taitworld.com

Website: <http://support.taitworld.com>.

